

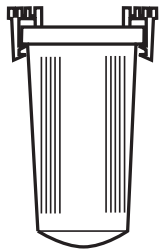

LV 9000, LV 9500

Snap-Locking Waterproof Connectors Pre-Filled with Silicone

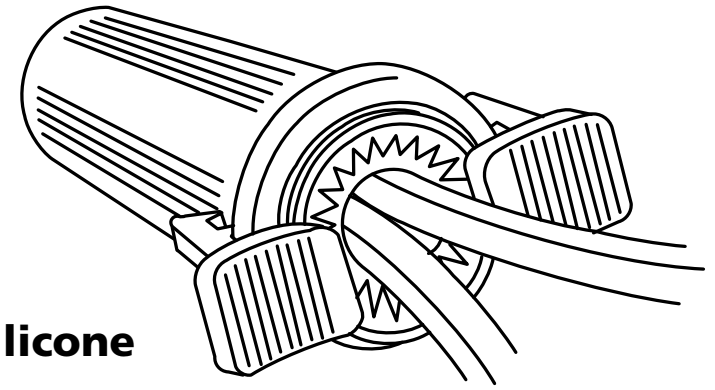

LV 9000 24 to 18 AWG - Yellow

Minimum 2 #24 AWG - Maximum 5 #18 AWG

- 1.1550in, 29.34mm wide (handles)
- .772 in, 19.55mm wide (cylinder top)
- 1.849 in, 46.96mm (at tallest including handles)

- o Sealant temperature - -40° F to 400° F
- o Copper and/or aluminum wires, solid or stranded
- o For low-voltage connections only - Maximum 30 Volts

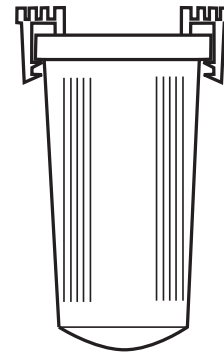

LV 9500 18 to 10 AWG - Black

Minimum 2 #18 AWG - Maximum 3 #10 AWG with 1 #18 AWG

- 1.480in, 37.64mm wide (handles)
- 1.157 in, 29.63 mm wide (cylinder top)
- 2.270 in, 57.68mm (at tallest including handles)

- o Sealant temperature - -40° F to 400° F
- o Copper and/or aluminum wires, solid or stranded
- o For low-voltage connections only - Maximum 30 Volts

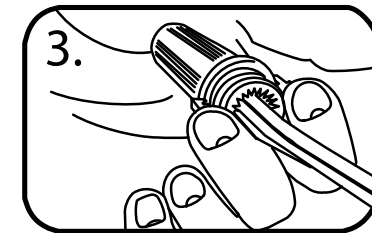
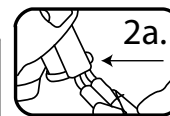
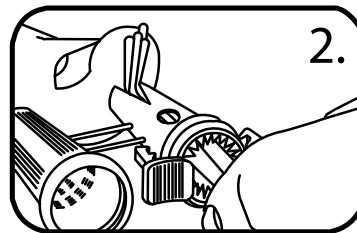
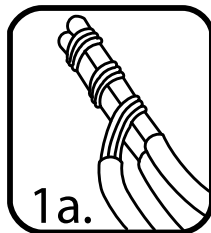
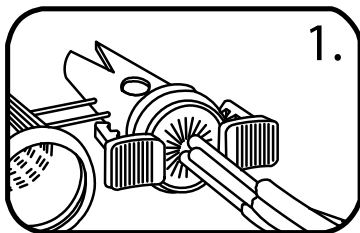

1. Strip wires 1" and group bare wire ends together. Do not pre-twist solid wire. You must pre-twist stranded wire. If using both wire types, you must wrap stranded wire around untwisted solid wires (see illustration 1a).
2. Insert wires through flexible sealing fingers and bend bare wire ends together into one "V-Channel". When connecting heavy solid wires, use bending sleeve / depth gauge on outer sleeve of connector (see illustration 2a). For larger connections (e.g. three #12 wires, or equivalent, or more), bend wires into the "V-Channel" with round hole at bottom (see illustration 2b); pull folded group of wires downward into this hole at bottom of "V-Channel".
3. Separate connector, removing plastic "link" or "leg" from inner sleeve. Push inner sleeve into pre-filled outer sleeve until double-locked. Ensure that bending sleeve does not come down over either latch. Pre-filled silicone fully waterproofs the connection. Do not reuse.